

### Ordering Procedure

The following information is essential for replacement order processing:

- Engine model and serial number (see engine name plate)
- Number of Parts Catalog (see catalog front page)
- Illustration table number
- Callout number
- Quantity and designation
- Order number

When ordering replacement parts for ancillary equipment such as injection pumps, fuel pumps, etc., indicate both model and part number of the ancillaries.

Phone orders should be confirmed in writing to prevent errors.

### Ordering Scheme

Engine model ...	Engine serial No. ...	Parts catalog No. ...		
Illust. Table No.	Callout No.	Qty	Designation	Part No.
03 80	07	1	Crankshaft gear	555 052 00 03

### Factory Repairs

Parts shipped to MTU for repair should have an engine serial number identification (tag or label, for example).

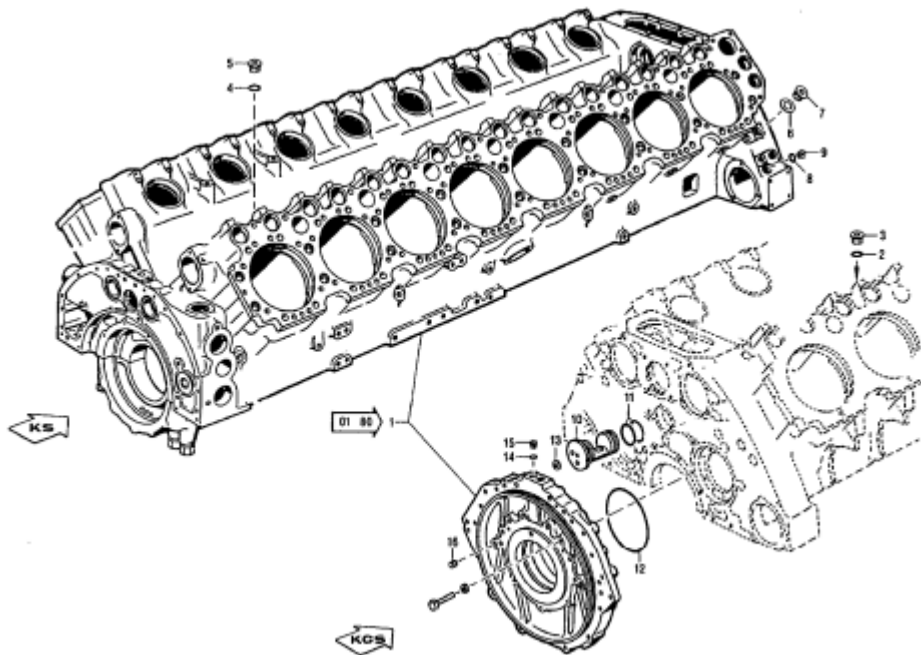

<b>EDITION :</b>		03.02	GAPL 01	KURBELGEHAUSE				<b>CATALOG :</b>	M034527/00DE
			EGC : 01	CRANKCASE				<b>ILLUST.TABLE:</b>	01 01
<b>PROJECT</b>		0CXE	GA/SA/KW :	559.944-01				<b>REG.NO. :</b>	0040A0
ORTZ	BESTELLNUMMER	BENENNUNG	STO	BZEH	FN	ZUSATZBEZ. / SUPPLEMENTARY DESIGNATION	POS.-NR.		
C/N	PART NO.	DESIGNATION	Q/U	U/M	FN	BEMERKUNG / REMARKS	ITEM		
01	559 010 40 06	ZB KURBELGEHAUSE CRANKCASE	1	EA			010002		
02	007603 020101	DICHTRING SEALING RING	2	EA		A 20 X 24 DIN 7603 CU	010004		
03	000908 020000	VERSCHLUSSSCHRAUBE PLUG	2	EA		M 20 X 1,5 DIN 908 ST DBL 9400.0	010006		
04	007603 026104	DICHTRING SEALING RING	1	EA		A 26 X 31 DIN 7603 CU	010008		
05	000908 026005	VERSCHLUSSSCHRAUBE PLUG	1	EA		M 26 X 1,5 DIN 908 ST DBL 8451.2	010010		
06	007603 022102	DICHTRING SEALING RING	2	EA		A 22 X 27 DIN 7603 CU	010012		
07	000908 022001	VERSCHLUSSSCHRAUBE PLUG	2	EA		M 22 X 1,5 DIN 908 ST DBL 8451.2	010014		
08	007603 016105	DICHTRING SEALING RING	1	EA		A 16 X 20 DIN 7603 CU	010016		

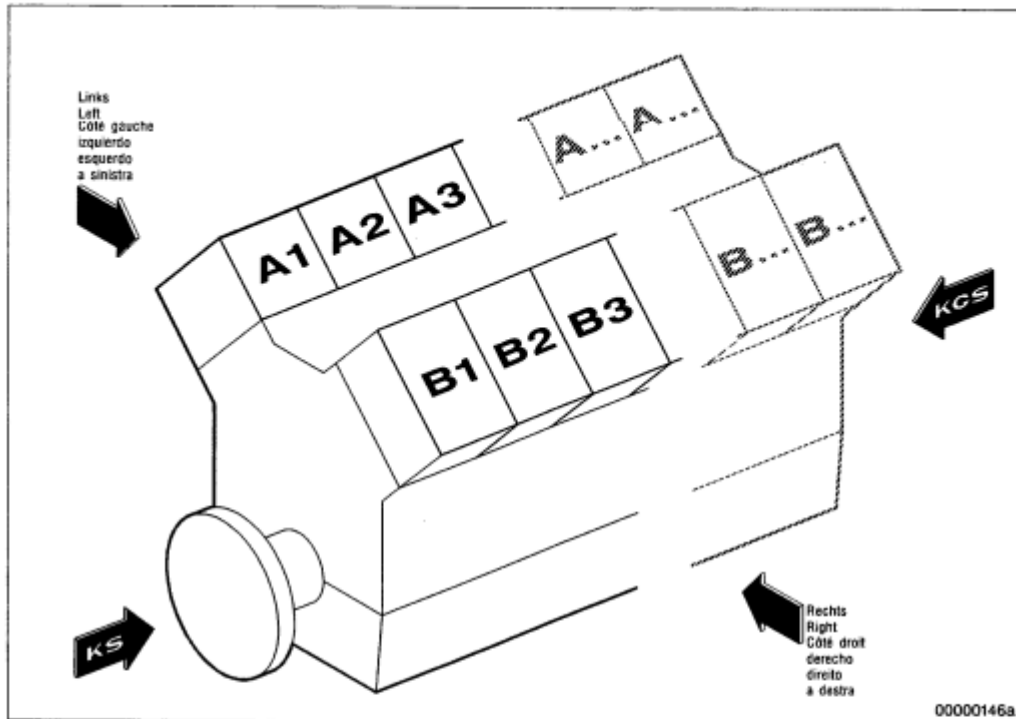

00000146a

Engine sides are always designated as viewed from driving end.

The left bank of cylinders is marked „A“ and the right bank „B“ (according to DIN ISO 1204).

The cylinders of each bank are numbered consecutively, starting with No. 1 at the drive end.

Numbering of other engine components is also from the drive end, starting with No. 1.

#### Designations and Abbreviations

Driving end	=	KS
Free end	=	KGS
Left side		
Right side		
Upper side		
Lower side		
Turbocharger	=	ATL

<b>EDITION :</b>	03.02	<b>GAPL 01</b>	KURBELGEHAEUSE	<b>CATALOG :</b>	M034527/00DE
		<b>EGC : 01</b>	CRANKCASE	<b>ILLUST.TABLE:</b>	01 03
<b>PROJECT</b>	0CXE	<b>GA/SA/KW :</b>	559.944-01	<b>REG.NO. :</b>	066623

ORTZ	BESTELNUMMER	BENENNUNG	STO	BZEH	FN	ZUSATZBEZ. / SUPPLEMENTARY DESIGNATION	POS.-NR.
CIN	PART NO.	DESIGNATION	QU	UM	FN	BEMERKUNG / REMARKS	ITEM
01	007603 012110	DICHTRING SEALING RING	1	EA		A 12 X 17 DIN 7603 CU	010134
02	000908 012003	VERSCHLUSSSCHRAUBE PLUG	1	EA		M 12 X 1,5 DIN 908 ST DBL 8451.2	010136
03	555 010 12 35	ZB ABSCHLUSSDECKEL END COVER	1	EA			010138
04	550 011 06 80	DICHTBEILAGE GASKET	1	EA			010140
05	000125 008427	SCHEIBE WASHER	11	EA		A 8,4 DIN 125 140 HV DBL 8451.11	010142
06	304017 008084	SECHSKANTSCHRAUBE SCREW	2	EA		M 8 X 35 ISO 4017 8.8 A3C	010144
07	304017 008086	SECHSKANTSCHRAUBE SCREW	7	EA		M 8 X 45 ISO 4017 8.8 A3C	010146
08	304017 008089	SECHSKANTSCHRAUBE SCREW	1	EA		M 8 X 60 ISO 4017 8.8 A3C	010148